

Coupe 2-2
(Ech. 1/10)

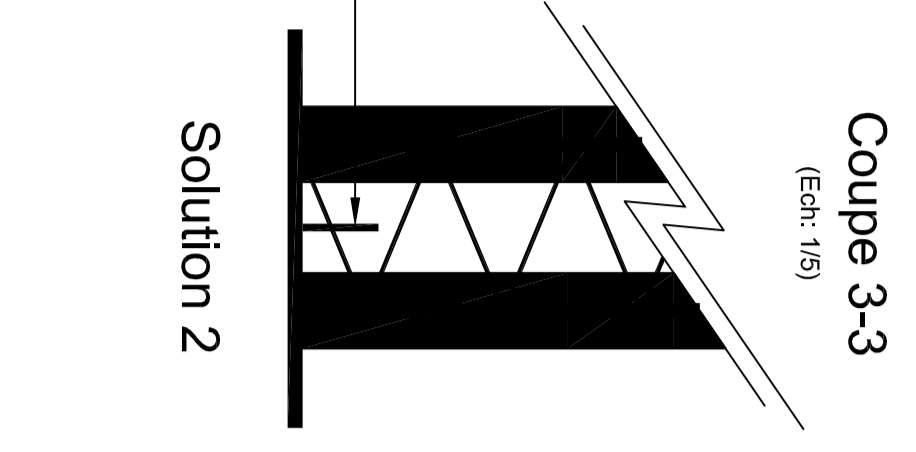

Coupe 3-3
(Ech. 1/5)

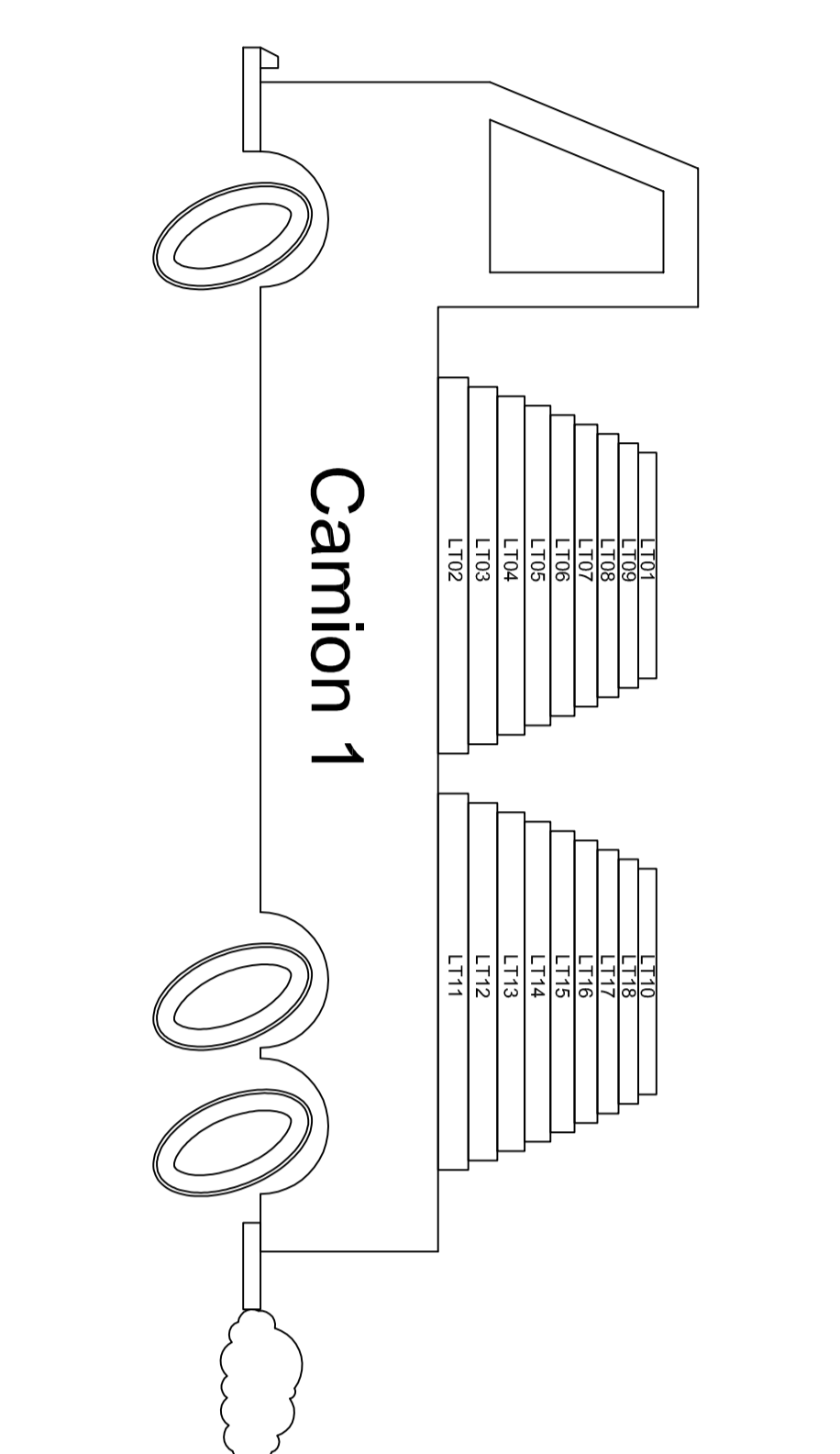

Camion 1

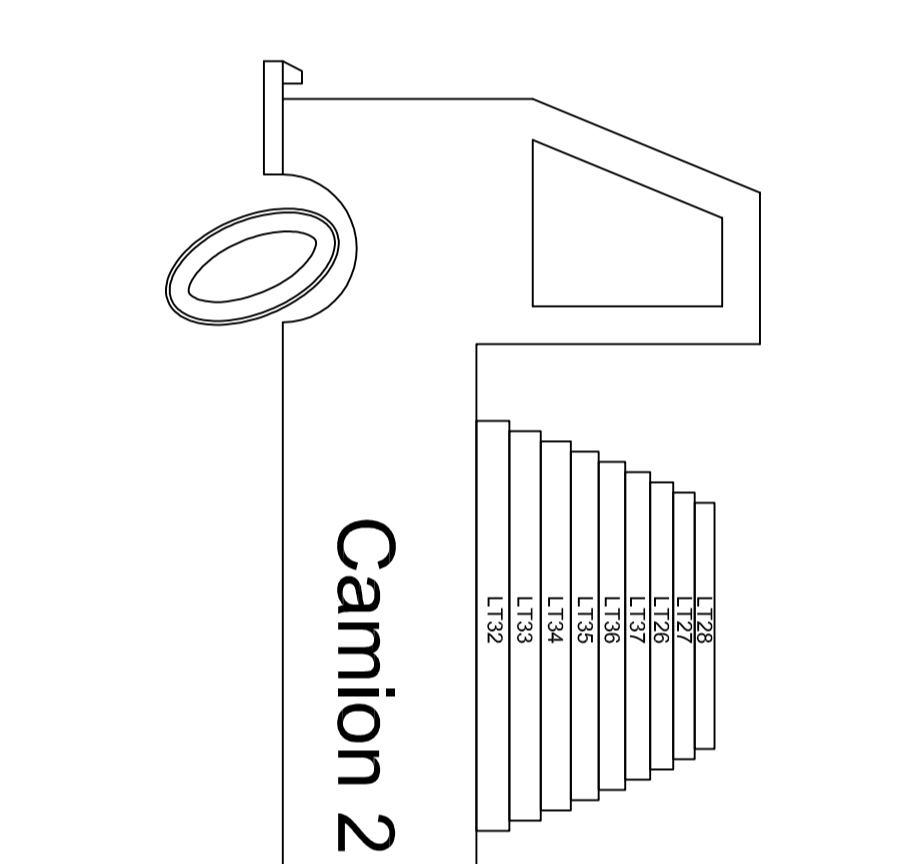

Camion 2

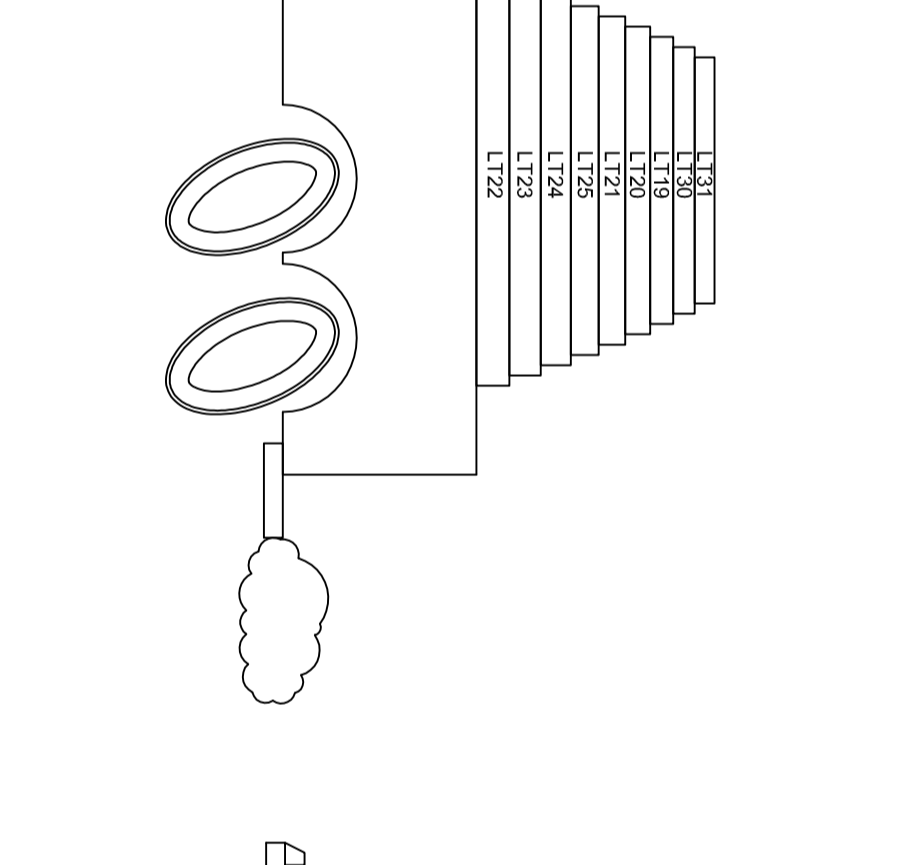

Camion 3

N°	Panneau	Masse (kg)	Recouvrement (mm)	Dimensions (mm)	Masse (kg)
T1	ST10	1	1	2 x 2.40x3.72	4.193
T2	ST10	1	1	1 x 2.40x2.48	4.05
T3	ST10	1	1	1 x 2.40x0.95	4.05
T4	ST10	1	1	1 x 2.40x1.72	7.55
T5	ST10	1	1	1 x 2.40x1.14	70.00
T6	ST10	1	1	4 x 2.40x1.14	35.14
T7	ST10	1	1	3 x 2.40x2.61	8.01
T8	ST10	1	1	1 x 0.99x0.74	14.91
T9	ST10	1	1	1 x 2.40x1.48	23.88
T10	ST10	1	1	1 x 0.52x1.50	12.29
T11	ST10	1	1	1 x 2.40x3.00	26.76
T12	ST10	1	1	1 x 2.40x3.94	12.77
T13	ST10	1	1	1 x 2.40x1.97	22.74
T14	ST10	1	1	1 x 2.40x1.97	9.00
T15	ST10	1	1	2 x 2.40x3.92	34.38
T16	ST10	1	1	2 x 2.40x3.72	45.52
T17	ST10	1	1	1 x 10.9x1.86	14.87
T18	ST10	1	1	1 x 2.40x1.86	8.07
T19	ST10	1	1	1 x 2.40x1.98	10.61
T20	ST10	1	1	1 x 2.40x2.40	25.71
T21	ST10	1	1	1 x 2.40x2.80	53.67
T22	ST10	1	1	1 x 2.40x3.82	32.96
T23	ST10	1	1	2 x 2.40x3.90	34.56
T24	ST10	1	1	1 x 1.12x1.95	21.61
T25	ST10	1	1	1 x 2.40x3.90	9.39
T26	ST10	1	1	1 x 0.17x1.95	30.10
T27	ST10	1	1	1 x 2.40x3.69	44.73
T28	ST10	1	1	1 x 1.09x1.23	9.02
T29	ST10	1	1	1 x 2.40x2.46	34.3
T30	ST10	1	1	1 x 1.96x2.61	4.99
T31	ST10	1	1	3 x 2.40x2.61	
T32	ST10	1	1	1 x 2.40x2.33	
T33	ST10	1	1	1 x 0.66x0.60	
T34	ST10	1	1	1 x 2.40x0.60	
T35	ST10	1	1	1 x 0.53x0.50	
T36	ST10	1	1	1 x 2.40x1.00	

Masse posée : 613 kg

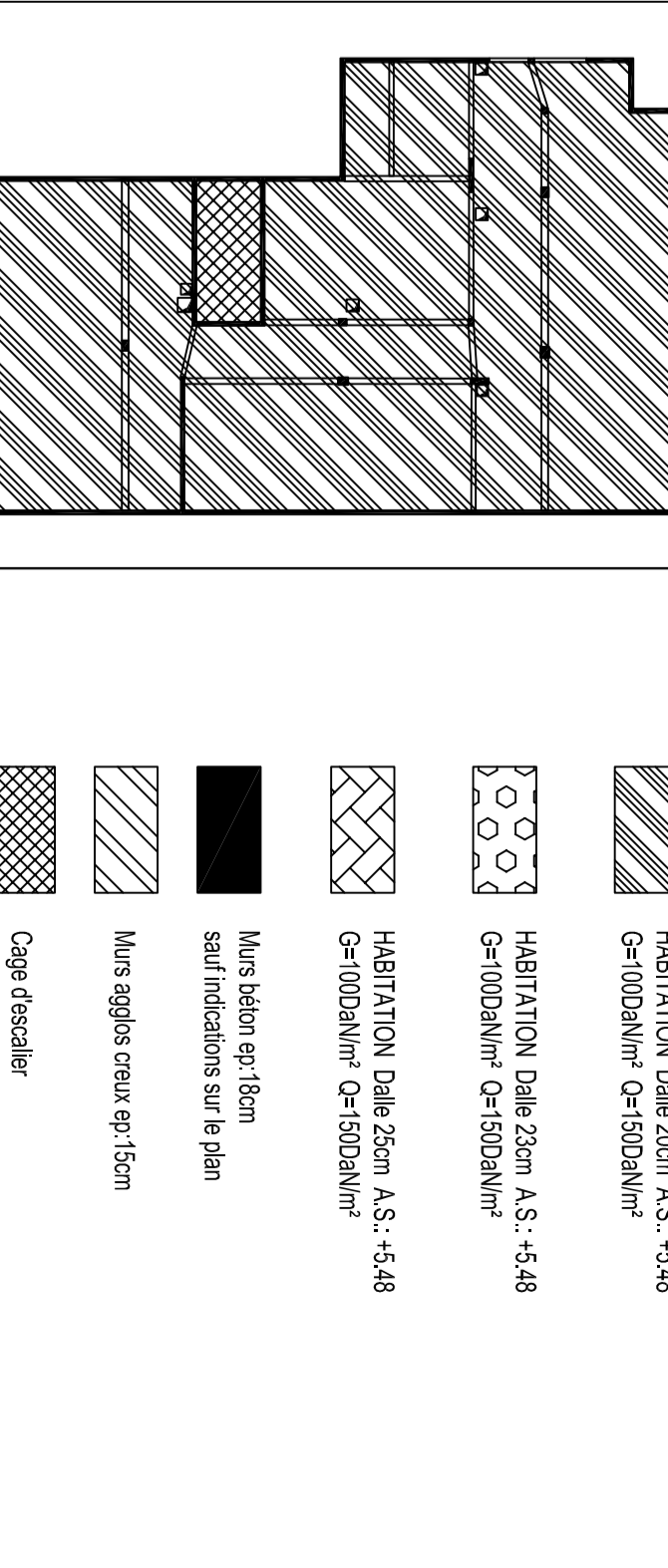

EHPAD
ST. ETIENNE

Plancher Prédalles
Coffrage & Ferrillage
R+1 à R+3 Bloc 4

Maitre d'oeuvre
CITE NOUVELLE
13 place Jean Jaures 42029 SAINT ETIENNE
0477423780 fax: 0477423781
e-mail: citenouvelle@citnouvelle.fr

Maitre d'ouvrage
AD2H
2bis Allée Lorraine 42803 MONTBRISON
0477589761 Fax: 0477589670
e-mail: ad2h@ad2h.fr

Entreprise
EFFRAGE CONSTRUCTION LOIRE
3 rue Paul de Bessy 42005 SAINT ETIENNE
0477434700 Fax: 0477434700
e-mail: benjamin.dapillon@effr.com

BET
VTB et Associés
BP 10820 - rue Claude Odde 42952 St ETIENNE
0477434700 Fax: 0477434700

Dessinateur : Joëlyn Souquet
Vérifié par : A. Armandot

Indice	Modification	Date
0	1ère Emission	24/11/2015
A		
B		
C		

Projet :	Phase :	Lot :	Affaire :	N°
EHPAD	EXE	GO	15-001	001

Ech. : 1/50